

ASSEMBLY
(PLAN OR SECTION VIEW)

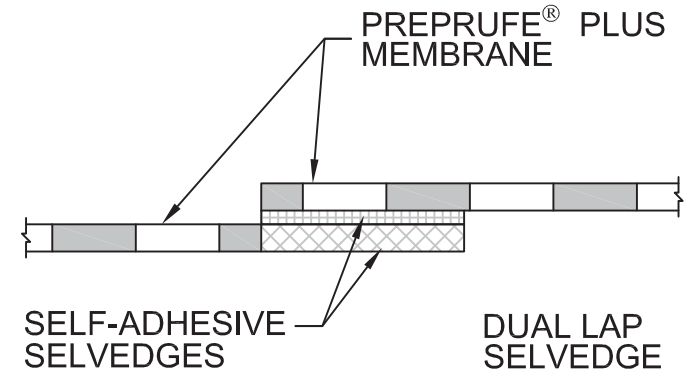

FINISHED
(PLAN OR SECTION VIEW)

NOTES:

- POSITION SUCCEEDING SHEETS TO OVERLAP THE PREVIOUS SHEET 3 IN. (75 mm) ALONG THE MARKED SELF-ADHESIVE SELVEDGE
- PEEL BACK BOTH THE GREEN AND BLUE ZIP STRIPS SIMULTANEOUSLY IN THE OVERLAP AREA TO ACHIEVE AN ADHESIVE TO ADHESIVE BOND
- ROLL FIRMLY INTO PLACE



SIDE LAP

PREPRUFE[®] PLUS WATERPROOFING SYSTEM

DRAWING: PRE-059
SCALE: Not to Scale
EFFECTIVE DATE: 07/01/16
SUPERSEDES: 04012015

INSTALLATION INSTRUCTIONS

Preprufe® Plus Side Lap

Prior to Membrane Installation, Review the Preprufe® Plus Data Sheet



Surface Prep

All surfaces must be sound and solid to eliminate movement during the concrete pour. Substrate must be regular and smooth with no gaps or voids greater than ½ inch. The surface should also be free from loose aggregate and sharp protrusions as outlined in the Preprufe® Plus Data Sheet section on Surface Preparation.

Detailing

1. Install Preprufe Plus Membrane in accordance with the Preprufe Plus Data Sheet section on Installation.
2. Position succeeding sheets to overlap the previous sheet 3 in. (75 mm) along the marked self-adhesive selvedge.
3. Peel back both the green and blue zip strips simultaneously in the overlap area to achieve an adhesive to adhesive bond.
4. Roll firmly into place.

Special Notes

Preprufe membranes should not be used in areas where they will be permanently exposed to sunlight, weather or traffic. Protect membrane from sunlight as quickly as possible after installation.